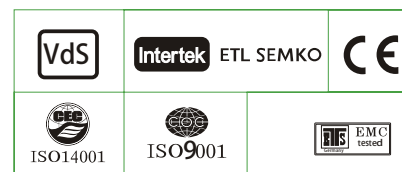

Specification

Nominal Voltage	2V		
Nominal Capacity(10HR)	1500.0AH		
Dimensions	Length	403±3mm (15.87 inches)	
	Width	354±3mm (13.94 inches)	
	Container Height	339±3mm (13.35 inches)	
	Total Height (with Terminal)	349±3mm (13.74 inches)	
Approx Weight	Approx 94.0 kg (207.2lbs)		
Terminal	T11		
Container Material	ABS		
Rated Capacity	1576.0AH/78.8A	(20hr, 1.80V/cell, 25°C/77°F)	
	1500.0AH/150.0A	(10hr, 1.80V/cell, 25°C/77°F)	
	1305.0AH/261.0A	(5hr, 1.75V/cell, 25°C/77°F)	
	1134.0AH/378.0A	(3hr, 1.75V/cell, 25°C/77°F)	
	910.5AH/910.5A	(1hr, 1.60V/cell, 25°C/77°F)	
Max. Discharge Current	12000A (5s)		
Internal Resistance	Approx 0.35mΩ		
Operating Temp. Range	Discharge :	-15~50°C (5~122°F)	
	Charge :	0~40°C (32~104°F)	
	Storage :	-15~40°C (5~104°F)	
Nominal Operating Temp. Range	25±3°C (77±5°F)		
Cycle Use	Initial Charging Current less than 450.0A. Voltage 2.4V~2.5V at 25°C(77°F)Temp. Coefficient -5mV/°C		
	No limit on Initial Charging Current Voltage 2.25V~2.3V at 25°C(77°F)Temp. Coefficient -3mV/°C		
Standby Use	40°C (104°F) 103%		
Capacity affected by Temperature	25°C (77°F) 100%		
	0°C (32°F) 86%		
	GFM series batteries may be stored for up to 6 months at 25°C(77°F) and then a freshening charge is required. For higher temperatures the time interval will be shorter.		
Self Discharge			

Applications

- ◆ Tele-communication central station(wired or cellular)
- ◆ Power system communication, military communication, etc.
- ◆ Network communication including: data transmission, television signal transmission, etc.
- ◆ Uninterruptable Power System (UPS- for Telecom)

Constant Current Discharge (Amperes) at 25°C (77°F)

F.V/Time	30min	45min	1h	2h	3h	4h	5h	6h	8h	10h	20h
1.85V/cell	1150.2	912.0	748.5	449.6	347.5	285.4	243.0	212.3	171.0	143.3	76.0
1.80V/cell	1234.1	959.5	795.0	474.3	364.5	298.1	253.2	221.8	177.6	150.0	78.8
1.75V/cell	1306.9	1008.9	829.5	494.0	378.0	308.3	261.0	227.0	180.9	151.5	79.5
1.70V/cell	1371.3	1046.9	858.6	508.5	388.0	315.0	265.5	231.0	183.8	153.0	80.3
1.65V/cell	1438.4	1092.5	889.5	523.8	396.5	321.8	271.2	235.0	186.4	155.0	81.3
1.60V/cell	1488.0	1122.0	910.5	536.3	405.0	326.3	275.1	238.3	188.8	156.8	82.3

Constant Power Discharge (Watts) at 25°C (77°F)

F.V/Time	30min	45min	1h	2h	3h	4h	5h	6h	8h	10h	20h
1.85V/cell	2198.1	1753.5	1447.8	874.5	679.1	559.7	478.7	419.4	339.3	284.9	151.3
1.80V/cell	2339.6	1832.6	1529.2	918.2	709.0	582.7	496.6	436.4	351.3	297.9	156.6
1.75V/cell	2458.7	1915.7	1588.5	952.4	733.3	600.5	510.2	445.4	357.2	300.5	157.9
1.70V/cell	2558.1	1974.0	1635.5	976.4	749.9	611.1	517.4	452.5	362.4	303.3	159.4
1.65V/cell	2663.4	2048.4	1684.8	1001.5	762.9	622.1	526.7	459.0	366.6	306.6	161.2
1.60V/cell	2727.5	2084.1	1712.7	1018.9	775.3	628.0	532.1	463.9	370.6	309.7	162.9

Dimensions

T11 Terminal

Unit: mm [inches]

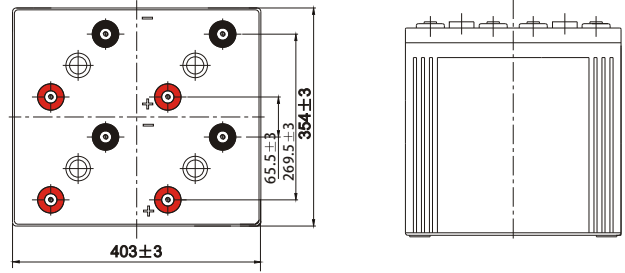
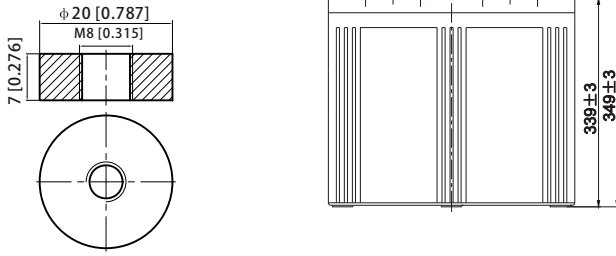

Discharge Characteristics

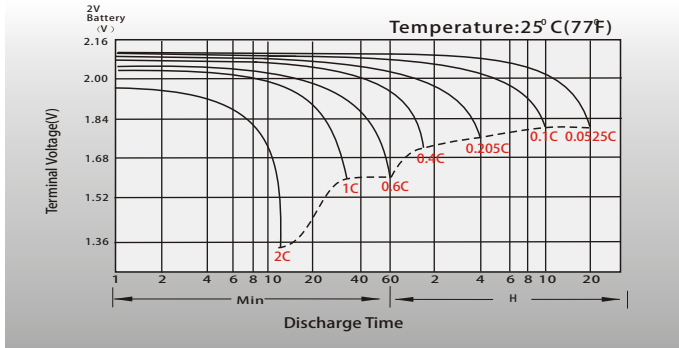

Float Charging Characteristics

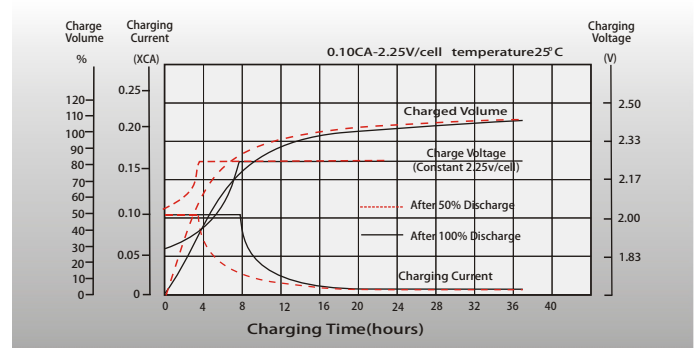

Temperature Effects in Relation to Battery Capacity

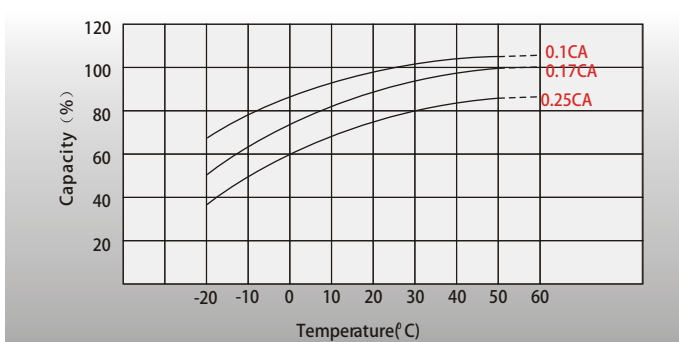

Effect of Temperature on Long Term Float Life

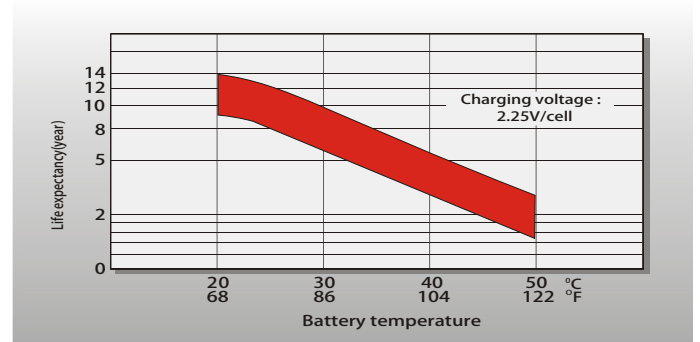

Cycle Life in Relation to Depth of Discharge

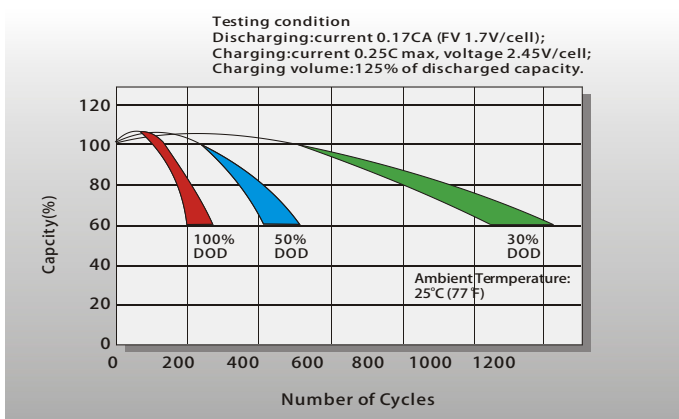

Self Discharge Characteristics

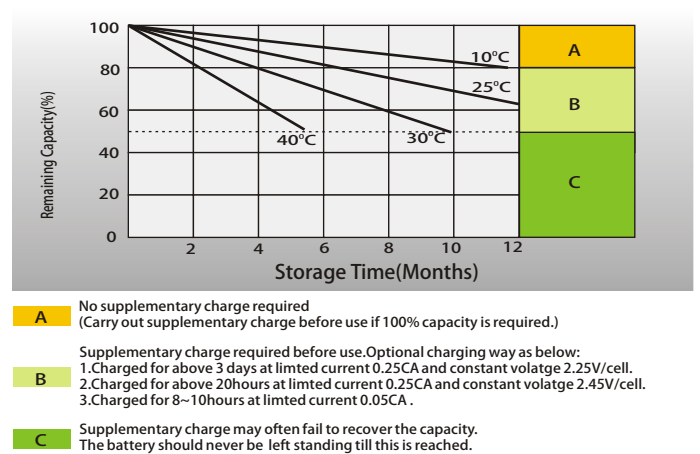

Contact US

Greensun Solar Energy Tech Co., Limited

* Add: No 2000 Changjiang West Road, Shushan District Hefei China
 * Email: info@greensunpv.com
 * Phone: 0551-69866216 Fax: 0551-69866218 Mob: 0086-158 5511 0194
 * Web: <https://www.greensunpv.com> & <https://greensunpv.en.alibaba.com>