

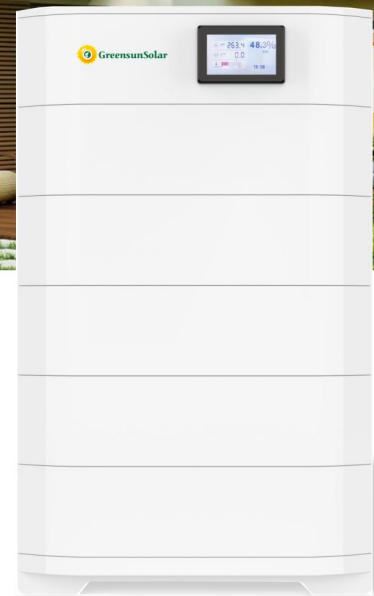

**GreensunSolar**



## Residential BESS HV Stackable LiFePO4 Battery System



**Safety & Reliable**

Excellent safety of LiFePO4 & Multi-protection from BMS



**Optimal Electricity Cost**

Long cycle life and superior performance



**Compact Size & East Installation**

Module and Stack design help for quick installation



**Easy to Scale Up**

Stackable type to expand capacity flexibly



**High compatibility BMS**

Seamless communication with most brands inverters



**Multi-Applications:**

Self-Use, Peak Shaving, UPS, Backup, ESS, HESS, BESS,  
Off Grid/Hybrid Solar System

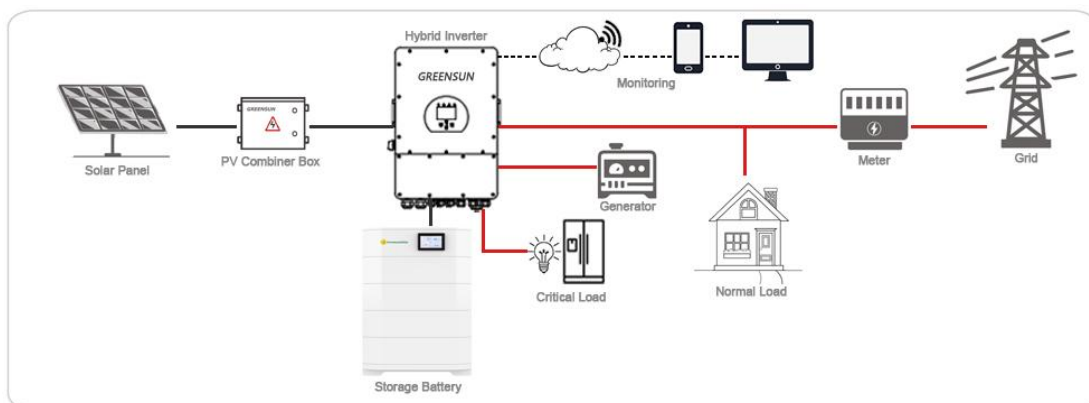

# Specifications(HV Battery System)



MODEL	GSB-16.28H	GSB-21.7H	GSB-27.13H	GSB-32.56H	GSB-37.98H	GSB-43.41H	GSB-48.84H	GSB-54.27H
Battery Type	LiFePO4(LFP)							
Battery Module	51.2V 106AH(5.427KWH, Size&Weight: 600x400x150mm, 45KG)							
<b>Battery System Data</b>								
Modules	3PCS in series	4PCS in series	5PCS in series	6PCS in series	7PCS in series	8PCS in series	9PCS in series	10PCS in series
Nominal Voltage	153.6V	204.8V	256V	307.2V	358.4V	409.6V	460.8V	512V
Nominal	16.28KWH	21.7KWH	27.13KWH	32.56KWH	37.99KWh	43.41KWH	48.84KWH	54.27KWH
Usable Capacity	14.65KWH	19.53KWH	24.41KWH	29.30KWH	34.19KWH	39.06KWH	43.95KWH	48.84KWH
Dimension (W*D*H )	600*400*685mm	600*400*835mm	600*400*985mm	600*400*1135mm	600*400*1285mm	600*400*1435mm	600*400*1585mm	600*400*1735mm
Weight	175kg	220kg	265kg	310kg	355kg	400kg	445kg	490kg
Operating Voltage Range	134-172.8V	179-230.4V	224-288V	268-345.6V	313.6-403.2V	358-460.8V	403.2-518.4V	448-576V
Charge Current	100A(MAX); 20-50A(Recommended)							
Discharge Current	100A(MAX); 20-50A(Recommended)							
Cycle Life	6000Cycles, 25℃							
Internal Resistance	≤30mΩ							
<b>BMS</b>								
Power	<1.5W (Work) < 100mW(Sleep)							
Monitoring	SOC, System voltage, current, cell voltage, cell temperature, module temperature							
Communication	CAN/RS-485/WIFI							
<b>General</b>								
Operating Temp. Range	-10℃-50℃							
Transport or Storage Temp. Range	-20℃-45℃							
Humidity	10% - 95% (No Condensing)							
Design Life	15Years+							